

SUBDIVISION PLAN OF D.L. 1487, GP. 1, N.W.D.

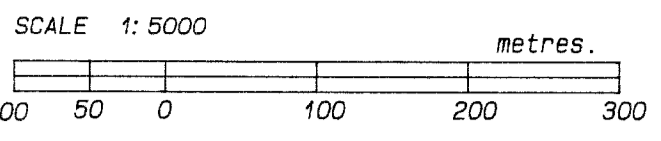

B.C.G.S. 92F.079

WATER ACCESS ONLY

This plan lies within the Sunshine Coast Regional District.

PLAN LMP 34416

REF. BL 282399

Deposited in the Land Title Office at New Westminster, B.C. this 14th day of Aug. 1997.

Registrar

Approved under the Land Title Act, this 14th day of August, 1997.

Approving officer - Ministry of Transportation and Highways

This plan need not comply with Section 75(1b) of the Land Title Act, due to difficult terrain.

For the Minister of Transportation and Highways
Dated this 14th day of August, 1997.

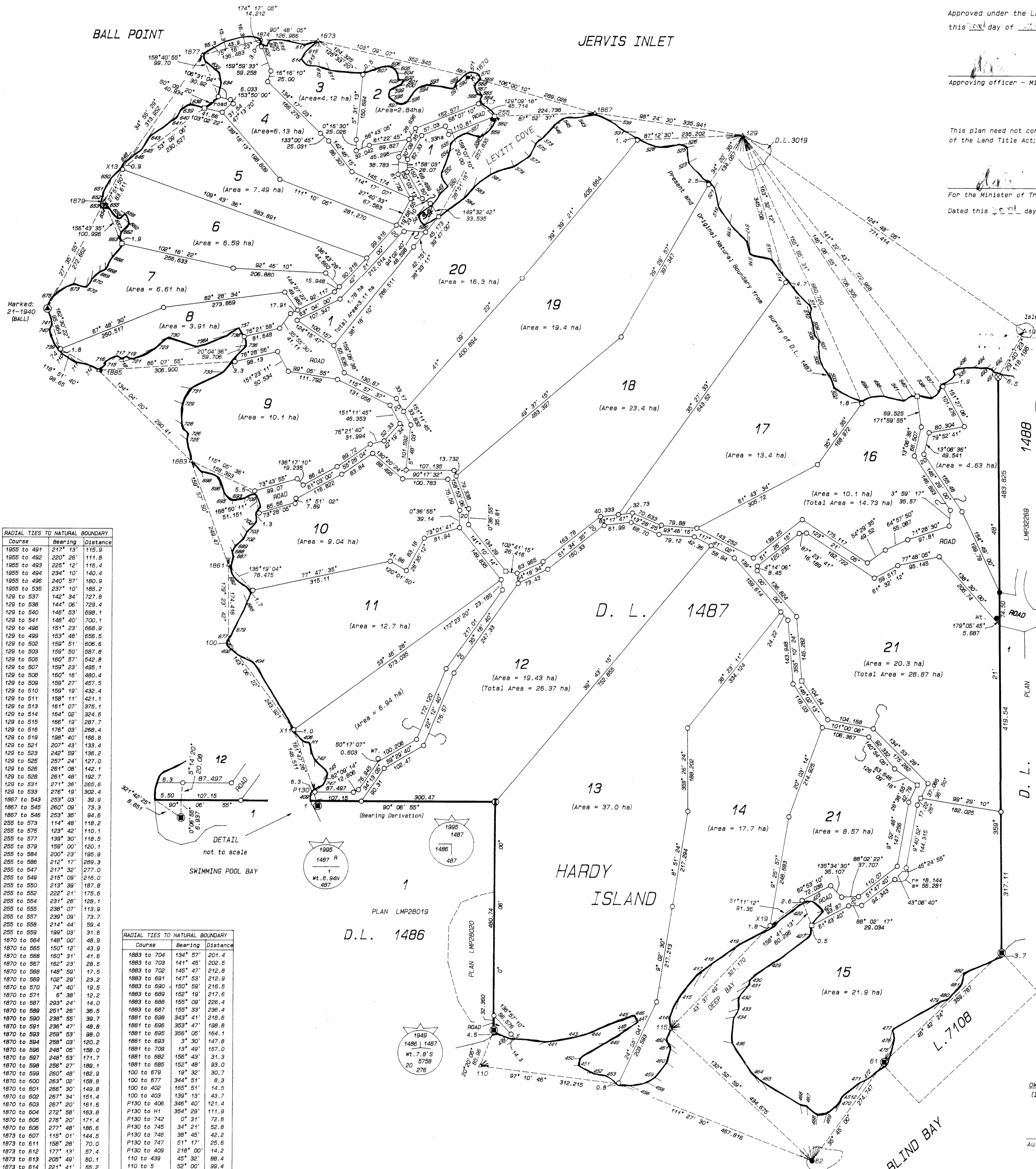

RADIAL TIES TO NATURAL BOUNDARY

| Course | Bearing | Distance |
|-------------|----------|----------|
| 1955 to 491 | 217° 13' | 115.9 |
| 1955 to 492 | 220° 26' | 111.8 |
| 1955 to 493 | 225° 12' | 116.4 |
| 1955 to 494 | 234° 40' | 140.4 |
| 1955 to 496 | 240° 57' | 160.9 |
| 1955 to 535 | 237° 10' | 165.2 |
| 129 to 537 | 142° 34' | 727.8 |
| 129 to 538 | 144° 26' | 729.4 |
| 129 to 540 | 148° 53' | 698.1 |
| 129 to 541 | 149° 40' | 700.1 |
| 129 to 542 | 151° 23' | 666.9 |
| 129 to 543 | 153° 08' | 656.6 |
| 129 to 544 | 155° 51' | 606.6 |
| 129 to 545 | 159° 50' | 587.8 |
| 129 to 546 | 163° 57' | 542.6 |
| 129 to 547 | 168° 23' | 485.1 |
| 129 to 548 | 172° 36' | 460.4 |
| 129 to 549 | 176° 40' | 427.0 |
| 129 to 550 | 180° 23' | 427.0 |
| 129 to 551 | 183° 56' | 376.1 |
| 129 to 552 | 187° 11' | 324.6 |
| 129 to 553 | 190° 11' | 287.7 |
| 129 to 554 | 192° 53' | 268.4 |
| 129 to 555 | 195° 40' | 268.4 |
| 129 to 556 | 198° 11' | 235.4 |
| 129 to 557 | 200° 23' | 195.9 |
| 129 to 558 | 202° 21' | 176.6 |
| 129 to 559 | 204° 07' | 128.1 |
| 129 to 560 | 205° 57' | 113.9 |
| 129 to 561 | 207° 39' | 73.7 |
| 129 to 562 | 209° 03' | 59.4 |
| 129 to 563 | 210° 44' | 31.6 |
| 1870 to 564 | 148° 00' | 48.9 |
| 1870 to 565 | 150° 12' | 43.9 |
| 1870 to 566 | 152° 31' | 41.6 |
| 1870 to 567 | 154° 29' | 26.5 |
| 1870 to 568 | 156° 59' | 17.5 |
| 1870 to 569 | 159° 29' | 12.2 |
| 1870 to 570 | 161° 59' | 12.2 |
| 1870 to 571 | 164° 29' | 14.0 |
| 1870 to 572 | 166° 59' | 36.5 |
| 1870 to 573 | 169° 29' | 36.7 |
| 1870 to 574 | 171° 59' | 48.8 |
| 1870 to 575 | 174° 29' | 98.0 |
| 1870 to 576 | 176° 59' | 116.6 |
| 1870 to 577 | 179° 29' | 120.1 |
| 1870 to 578 | 181° 59' | 158.8 |
| 1870 to 579 | 184° 29' | 149.8 |
| 1870 to 580 | 186° 59' | 151.4 |
| 1870 to 581 | 189° 29' | 161.6 |
| 1870 to 582 | 191° 59' | 163.8 |
| 1870 to 583 | 194° 29' | 174.4 |
| 1870 to 584 | 196° 59' | 186.6 |
| 1870 to 585 | 199° 29' | 144.5 |
| 1870 to 586 | 201° 59' | 70.0 |
| 1870 to 587 | 204° 29' | 57.4 |
| 1870 to 588 | 206° 59' | 50.1 |
| 1870 to 589 | 209° 29' | 55.2 |
| 1870 to 590 | 211° 59' | 35.1 |
| 1870 to 591 | 214° 29' | 30.2 |
| 1870 to 592 | 216° 59' | 84.6 |
| 1870 to 593 | 219° 29' | 103.2 |
| 1870 to 594 | 221° 59' | 19.1 |
| 1870 to 595 | 224° 29' | 16.4 |
| 1870 to 596 | 226° 59' | 102.8 |
| 1870 to 597 | 229° 29' | 85.0 |
| 1870 to 598 | 231° 59' | 75.8 |
| 1870 to 599 | 234° 29' | 111.8 |
| 1870 to 600 | 236° 59' | 132.6 |
| 1870 to 601 | 239° 29' | 152.7 |
| 1870 to 602 | 241° 59' | 162.4 |
| 1870 to 603 | 244° 29' | 232.8 |
| 1870 to 604 | 246° 59' | 399.9 |
| 1870 to 605 | 249° 29' | 394.8 |
| 1870 to 606 | 251° 59' | 405.8 |
| 1870 to 607 | 254° 29' | 426.5 |
| 1870 to 608 | 256° 59' | 237.6 |
| 1870 to 609 | 259° 29' | 213.6 |
| 1870 to 610 | 261° 59' | 180.0 |
| 1870 to 611 | 264° 29' | 124.8 |
| 1870 to 612 | 266° 59' | 102.6 |
| 1870 to 613 | 269° 29' | 111.5 |
| 1870 to 614 | 271° 59' | 144.0 |
| 1870 to 615 | 274° 29' | 158.1 |
| 1870 to 616 | 276° 59' | 209.0 |
| 1870 to 617 | 279° 29' | 219.1 |
| 1870 to 618 | 281° 59' | 239.7 |
| 1870 to 619 | 284° 29' | 276.3 |
| 1870 to 620 | 286° 59' | 60.4 |
| 1870 to 621 | 289° 29' | 107.9 |
| 1870 to 622 | 291° 59' | 122.7 |
| 1870 to 623 | 294° 29' | 89.3 |
| 1870 to 624 | 296° 59' | 24.2 |
| 1870 to 625 | 299° 29' | 73.0 |
| 1870 to 626 | 301° 59' | 148.1 |
| 1870 to 627 | 304° 29' | 178.1 |
| 1870 to 628 | 306° 59' | 244.8 |
| 1870 to 629 | 309° 29' | 262.1 |
| 1870 to 630 | 311° 59' | 206.2 |
| 1870 to 631 | 314° 29' | 204.1 |
| 1870 to 632 | 316° 59' | 167.7 |
| 1870 to 633 | 319° 29' | 159.3 |
| 1870 to 634 | 321° 59' | 144.9 |
| 1870 to 635 | 324° 29' | 143.8 |
| 1870 to 636 | 326° 59' | 7.7 |
| 1870 to 637 | 329° 29' | 29.7 |
| 1870 to 638 | 331° 59' | 56.2 |
| 1870 to 639 | 334° 29' | 74.5 |
| 1870 to 640 | 336° 59' | 149.7 |
| 1870 to 641 | 339° 29' | 243.5 |
| 1870 to 642 | 341° 59' | 268.3 |
| 1870 to 643 | 344° 29' | 336.3 |

RADIAL TIES TO NATURAL BOUNDARY

| Course | Bearing | Distance |
|-------------|----------|----------|
| 1893 to 704 | 134° 57' | 201.4 |
| 1893 to 705 | 141° 45' | 202.5 |
| 1893 to 706 | 148° 47' | 212.8 |
| 1893 to 707 | 155° 51' | 212.9 |
| 1893 to 708 | 162° 59' | 216.5 |
| 1893 to 709 | 169° 19' | 217.6 |
| 1893 to 710 | 175° 43' | 226.4 |
| 1893 to 711 | 181° 11' | 236.4 |
| 1893 to 712 | 186° 54' | 198.8 |
| 1893 to 713 | 192° 00' | 194.1 |
| 1893 to 714 | 197° 11' | 147.8 |
| 1893 to 715 | 202° 00' | 83.0 |
| 1893 to 716 | 206° 59' | 30.7 |
| 1893 to 717 | 211° 59' | 8.3 |
| 1893 to 718 | 216° 59' | 14.5 |
| 1893 to 719 | 221° 59' | 43.7 |
| P130 to 406 | 348° 40' | 121.4 |
| P130 to 407 | 354° 29' | 111.9 |
| P130 to 408 | 360° 00' | 72.6 |
| P130 to 409 | 365° 59' | 52.8 |
| P130 to 410 | 371° 59' | 42.2 |
| P130 to 411 | 377° 59' | 25.8 |
| P130 to 412 | 383° 59' | 14.2 |
| 110 to 413 | 389° 59' | 88.4 |
| 110 to 414 | 395° 59' | 99.4 |
| 110 to 415 | 401° 59' | 106.8 |
| 110 to 416 | 407° 59' | 228.2 |
| 110 to 417 | 413° 59' | 257.1 |
| 110 to 418 | 419° 59' | 347.3 |
| 110 to 419 | 425° 59' | 364.9 |
| 110 to 420 | 431° 59' | 386.9 |
| 110 to 421 | 437° 59' | 336.7 |
| 110 to 422 | 443° 59' | 283.8 |
| 110 to 423 | 449° 59' | 223.8 |
| 110 to 424 | 455° 59' | 162.4 |
| 110 to 425 | 461° 59' | 102.6 |
| 110 to 426 | 467° 59' | 44.9 |
| 82 to 427 | 295° 00' | 443.9 |
| 82 to 428 | 298° 11' | 426.4 |
| 82 to 429 | 301° 22' | 399.9 |
| 82 to 430 | 304° 33' | 364.8 |
| 82 to 431 | 307° 44' | 329.8 |
| 82 to 432 | 310° 55' | 294.8 |
| 82 to 433 | 314° 06' | 259.8 |
| 82 to 434 | 317° 17' | 224.8 |
| 82 to 435 | 320° 28' | 189.8 |
| 82 to 436 | 323° 39' | 154.8 |
| 82 to 437 | 326° 50' | 119.8 |
| 82 to 438 | 330° 01' | 84.8 |
| 82 to 439 | 333° 12' | 49.8 |
| 82 to 440 | 336° 23' | 14.8 |
| 82 to 441 | 339° 34' | 144.0 |
| 82 to 442 | 342° 45' | 158.1 |
| 82 to 443 | 345° 56' | 209.0 |
| 82 to 444 | 349° 07' | 219.1 |
| 82 to 445 | 352° 18' | 239.7 |
| 82 to 446 | 355° 29' | 276.3 |
| X19 to 422 | 80° 33' | 60.4 |
| X19 to 423 | 83° 44' | 107.9 |
| X19 to 424 | 86° 55' | 122.7 |
| X19 to 425 | 90° 06' | 89.3 |
| X19 to 426 | 93° 17' | 24.2 |
| X19 to 427 | 96° 28' | 73.0 |
| X19 to 428 | 99° 39' | 148.1 |
| X19 to 429 | 102° 50' | 178.1 |
| X19 to 430 | 106° 01' | 244.8 |
| X19 to 431 | 109° 12' | 262.1 |
| X19 to 432 | 112° 23' | 206.2 |
| X19 to 433 | 115° 34' | 204.1 |
| X19 to 434 | 118° 45' | 167.7 |
| X19 to 435 | 121° 56' | 159.3 |
| X19 to 436 | 125° 07' | 144.9 |
| X19 to 437 | 128° 18' | 143.8 |
| X19 to 438 | 131° 29' | 7.7 |
| X19 to 439 | 134° 40' | 29.7 |
| X19 to 440 | 137° 51' | 56.2 |
| X19 to 441 | 141° 02' | 74.5 |
| X19 to 442 | 144° 13' | 149.7 |
| X19 to 443 | 147° 24' | 243.5 |
| X19 to 444 | 150° 35' | 268.3 |
| X19 to 445 | 153° 46' | 336.3 |

The registered owners designated hereon declare that they have entered into a covenant in favour of the Province of British Columbia as represented by the Ministry of Health and Ministry Responsible for Seniors under section 219 of the Land Title Act.

The registered owners designated hereon declare that they have entered into a covenant in favour of the Province of British Columbia as represented by the Ministry of the Environment, Lands and Parks and the Sunshine Coast Regional District under section 219 of the Land Title Act.

Approved under section 82 of the Land Title Act, this 14th day of August, 1997.

Minister of Environment, Lands and Parks or the duly authorized designate.

The registered owners designated hereon hereby declare that they have entered into a covenant in favour of Her Majesty the Queen in the right of the Province of British Columbia, as represented by the Minister of Small Business, Tourism and Culture, Archaeological Branch under Section 219 of the Land Title Act.

The registered owners designated hereon hereby declare that they have entered into a covenant in favour of Her Majesty the Queen in the right of the Province of British Columbia, as represented by the Minister responsible for Environment and the Sunshine Coast Regional District under section 219 of the Land Title Act.

The registered owners designated hereon hereby declare that they have entered into a covenant in favour of Her Majesty the Queen in the right of the Province of British Columbia, as represented by the Minister of Transportation and Highways under section 219 of the Land Title Act.

1987
1487 1488
16 47
614
F.S. Remains of DP in Rock Cairn
F.S. O.B.T. (1891) 77' 5.6m
O.B.F. Snag Mkd. B.T. 28.
Made B.T.'s
0.45 Fir, 250' 1.2m
0.45 Fir, 16' 6.88m

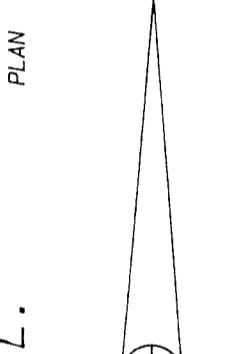

OWNER 460074 B.C. LTD
(INC. No. 460074)

Authorized signatory
R. Allen
Authorized signatory
R. Allen
Witness to both signatures

Name of witness
Address of witness
Occupation of witness

LEGEND
Bearings are astronomic and derived from Plan LMP28019. All distances are in metres.
● control (hydrographic) mon. found.
○ standard rock post found.
⊙ standard capped post found.
● standard iron post found.
○ standard iron post set.
□ lead plug set.
m² denotes square metres
Mt. denotes witness
B.T. denotes bearing tree
Bearings to B.T.'s are magnetic.

The natural boundary shown is the Present and Original Natural Boundary and coincides with the survey of D.L. 1487.
The public highway through Crown lands shown hereon is dedicated pursuant to Section 9(1) of the Ministry of Lands, Parks and Housing Act.
I, L.W. Penonzek, a British Columbia Land Surveyor, of the Town of Gibsons, in the Province of British Columbia, certify that I was present at and personally superintended the survey represented by this plan, and that the survey and plan are correct. The survey was completed on the 4th day of July, 1997.

For the Minister of Environment, Lands and Parks
Victoria, B.C. August 14, 1997.

L.W. Penonzek
L.W. Penonzek B.C.L.S.

Larry W. Penonzek
B.C. Land Surveyor
Box 505 Gibsons, B.C.
VON 1V0 Fx. 886-2553
Phone 886-2631